

Bayview Floor Plan

Main Bath (11' x 8' 6") - Includes a stand-up tub/shower, full size washer and dryer, and an abundance of storage space.

Kitchen w/Snack Bar & Dining Room (17' x 13') - The centerpiece of the unit is great for entertaining and cooking.

Pantry - Shelving & hot water heater.

Storage Closet (4' x 6')

Living Room (18' x 14') - spacious enough to accommodate large furniture & and a full size TV for your entertainment.

Private Entry-Way with Convenient Foyer Closet

Private Patio - Sliding glass doors welcome your guests to a covered patio large enough for outdoor dining and your enjoyment.

Large Walk-in-Closet (11' x 5') - This large walk in closet is 11' long and has plenty of room for additional storage space.

Master Bedroom (17' 10" x 10' 6") - This large bedroom has plenty of space for a king size bed and large dressers.

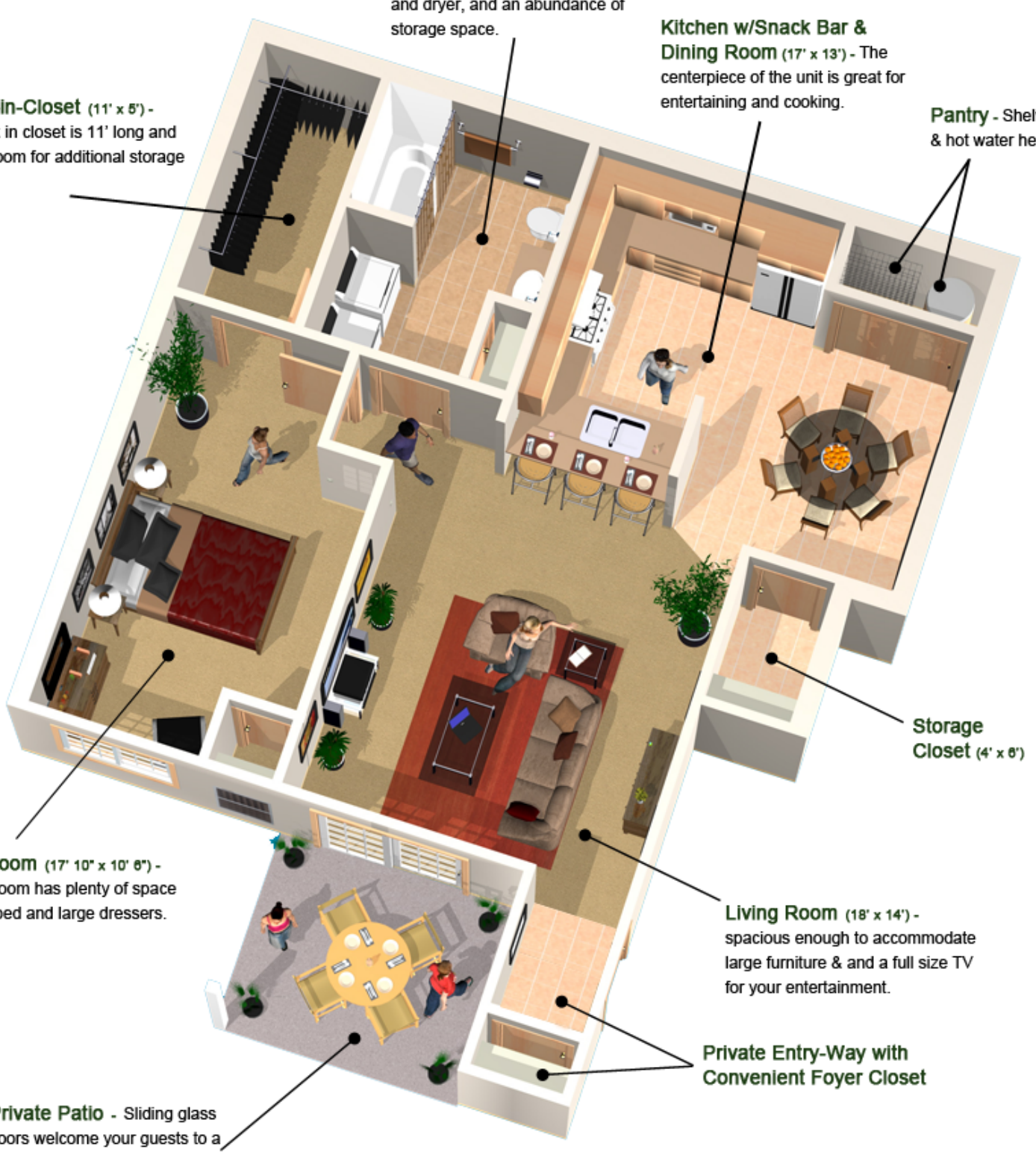

** Not all units are identical. Measurements and modifications are subject to change.